

THIS DRAWING IS TO BE READ IN CONJUNCTION WITH THE FULL SPECIFICATION

|                                   |           |
|-----------------------------------|-----------|
|                                   |           |
|                                   |           |
| Date                              | Revisions |
| © copyright <b>PAPER SIZE: A3</b> |           |

Client

Location

Proposal

Drawing Title

Scale

Date Drawn by

Drg No. Revision

REV A: INSTALL 110mm TOTAL CELOTEX INSULATION WITH 50mm BETWEEN RAFTERS AND A FURTHER 60mm OF CELOTEX FIXED ACROSS THE FACE, MAINTAINING 50mm CONTINUOUS AIRFLOW OVER U=0.20W/m<sup>2</sup>K. 13mm PLASTERBOARD AND SKIM FINISH TO UNDERSIDE.

PRE-FABRICATED COLLARED ROOF TRUSSES (DESIGN AND CALCULATIONS TO BE SUBMITTED TO THE LA PRIOR TO COMMENCEMENT ON SITE).

250mm TOTAL INSULATION QUILT WITH 100mm LAID BETWEEN CEILING MEMBERS AND A FURTHER 150mm LAID PERPENDICULAR ON TOP.

ESCAPE ROOFLIGHTS TO BE MAX 1100mm FROM FFL

100mm ROCKWOOL INSULATION QUILT LAID BETWEEN FLOOR JOISTS

175 x 50mm C16 FLOOR JOISTS @ 400C/C

2000 GAUGE POLYTHENE OVER INSIDE OF EXISTING WALLS WITH 50 x 50mm SOFTWOOD BATTENS AT 400mm CENTRES OVER THE TOP. 50mm THICK CELOTEX INSULATION BOARD IN BETWEEN BATTENS WITH 12.5mm THICK PLASTERBOARD AND SKIM OVER BATTENS.

EXISTING FOOTINGS TO BE EXPOSED (NEW FOUNDATION DESIGN I.E. UNDERPINNING MAY BE NECESSARY IF SO FULL DESIGN TO BE COMPLETED BY A STRUCTURAL ENGINEER).

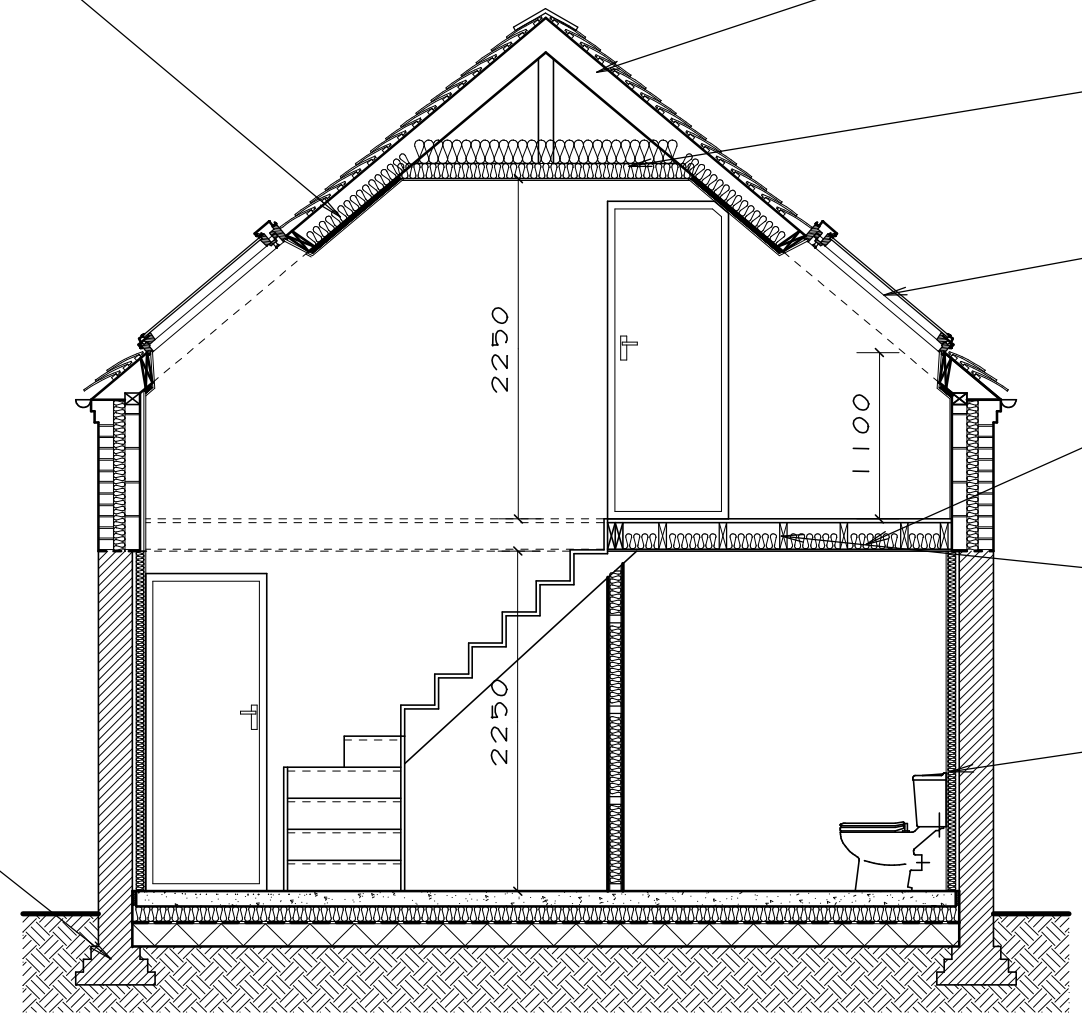

PROPOSED SECTION THROUGH TWO STOREY SECTION (1:50)

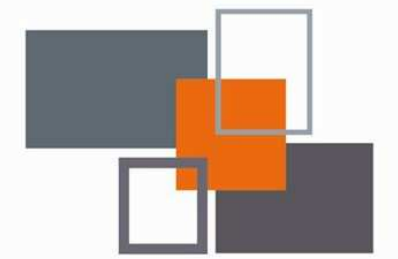

**MAKING PLANS**  
architecture

Ivy Lodge, Twyford Road, Willington, Derby. DE65 6DE  
T/F 01283 703160 E info@makingplans-architecture.co.uk  
W www.makingplans-architecture.co.uk